

KIT PHOTOVOLTAIC MODULES

KIT 190 BC SUPER BLACK

- ◆ Code 215690BC
- ◆ Photovoltaic Module MFBC190 (190W)
- ◆ Solar charge regulator PRM400
- ◆ Fixing kits KFPB670
- ◆ Cable entry gland KT6-PG
- ◆ Wiring kits KT51-C50

MFBC190 190W

MODEL	MFBC190
CODE	215986B
TYPE	PERC BACK CONTACT
CELLS NUMBER	60
RATED VOLTAGE	12V
MAX POWER	190 W
TOLERANCE	+3 %
OPEN CIRCUIT VOLTAGE	21,60V
SHORT CIRCUIT CURRENT	10,84 A
VOLTAGE AT MAX POWER	18,60 V
CURRENT AT MAX POWER	10,22 A
DIMENSIONS (mm)	1300 x 670 x 30
WEIGHT (Kg)	9,4

PRM400

MODEL	PRM400
CODE	204286
RATED VOLTAGE	12V
MAXIMUM POWER	350W (32+40 cells) – 400W (41+72 cells)
MAX POWER PHOTOVOLTAIC MODULES	2
PERFORMANCE	>95%
AUTOMATIC SHUTDOWN	In the absence of sunlight
END-OF-CHARGE VOLTAGE	-
FLOAT VOLTAGE	-
BATTERY TYPE SELECTOR	4 position dip-switch
NUMBER OF CHARGE LINES	8
BATTERY DESULPHATION	YES
REVERSE CURRENT BLOCKING PROTECTION	Electronic
REVERSE POLARITY PROTECTION	YES
TEST PANEL CONNECTION	PT 742
DIMENSIONS (mm)	150 x 110 H48

KFPB670



MODEL	PART-NR	DIMENSIONS (mm)	WEIGHT (Kg)
KFPB670 (black)	250425B	670 x 60 x 50	0,55

KT6-PG



MODEL	PART-NR	CABLE ENTRY GLAND complete with Pg16 cable gland for 2 cables with outer diameter 6mm ² .
KT6-PG	707063	

KT51-C50



MODEL	PART-NR	WIRING KIT FOR latest series of CBE photovoltaic modules complete with UV-resistant cable, 2x4 mm ² , length 5 metres.
KT51-C50	707073	

LINK A USER MANUAL FOR PRM400

You can download the full version of the user manual at the following link or by scanning the QR Code:

- <https://cbe.it/en/Catalogues>



WIRING DIAGRAM

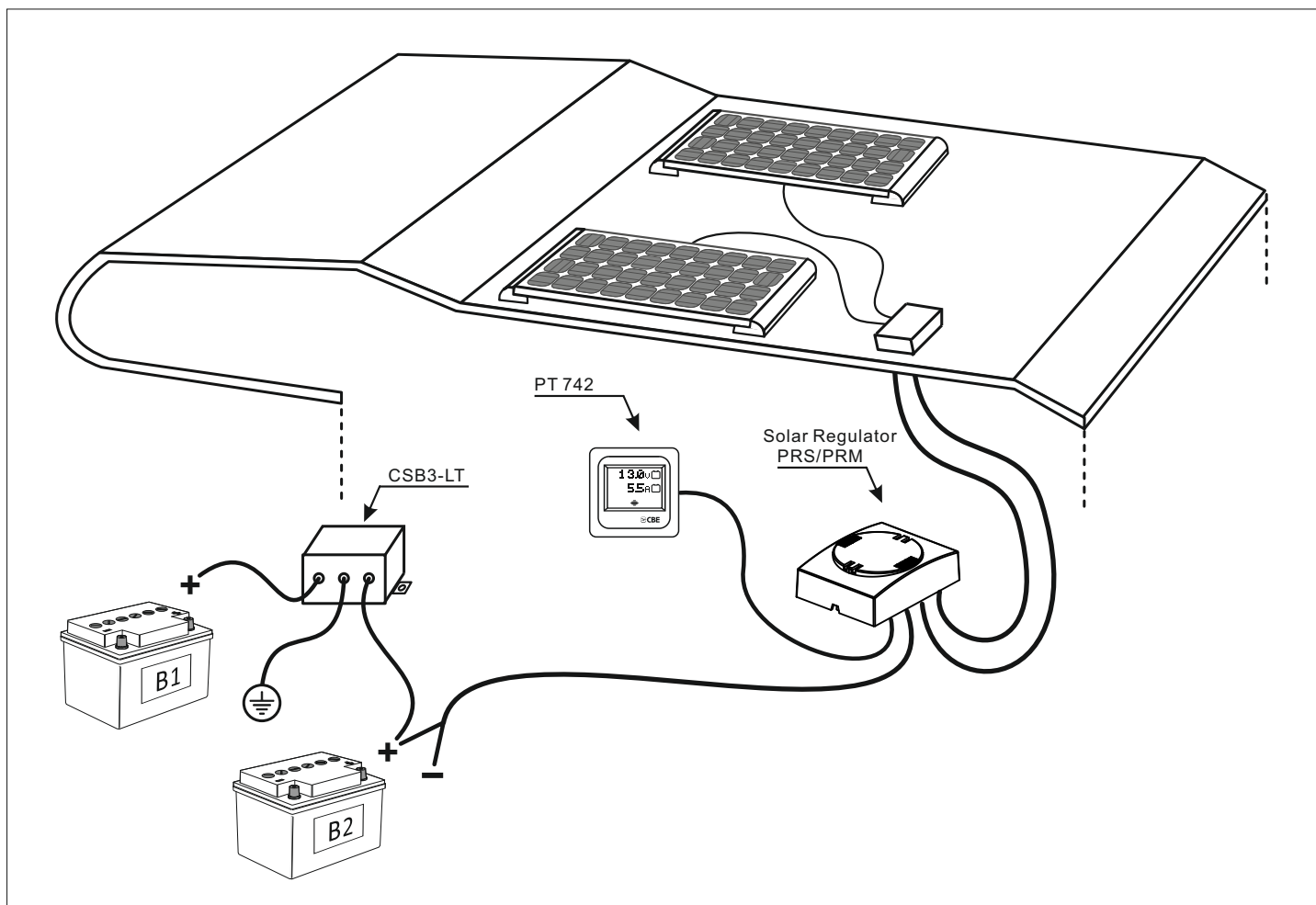

«KFPx» PHOTOVOLTAIC MODULE FIXING KIT

SPECIFICATIONS

- Specifically designed for motorhomes and caravans.
- Easy to install, no holes required.
- It can be installed in a few minutes with glue.
- It can be also installed on uneven surfaces.
- Light and aerodynamic.
- Anodized aluminium structure.



INSTALLATION

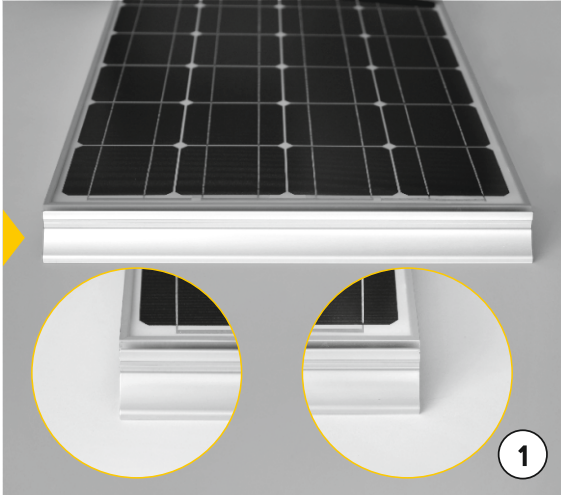

Position the photovoltaic module on the aluminium spoiler (central alignment).

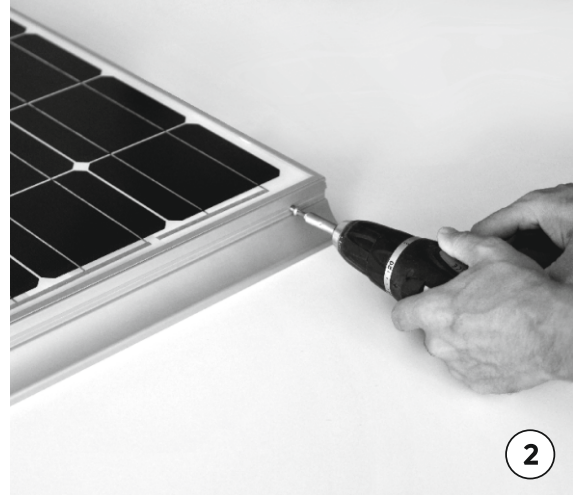

Use the two self-drilling screws to fasten the spoiler and the panel together.

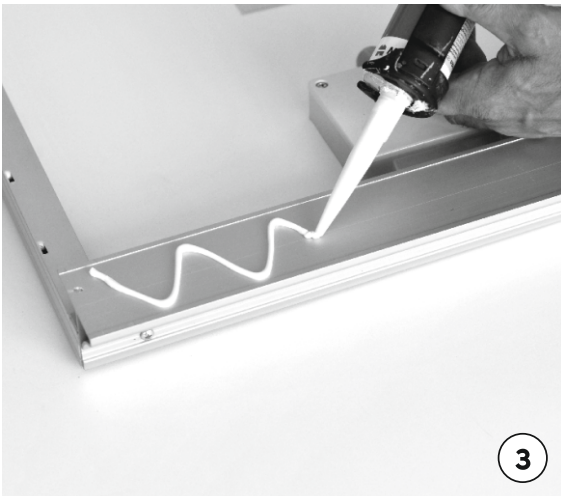

Spread the weatherproof polyurethane glue on the spoiler.



Use a degreasing agent to clean the motorhome roof and glue the spoiler on it. Let the glue dry.

ATTENTION: Glue not included in the package.
