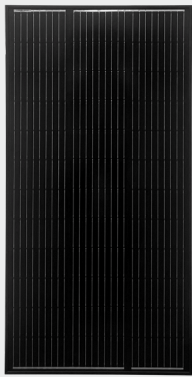

KIT PHOTOVOLTAIC MODULES

KIT SMALL 105 BLACK

- ◆ Code 215685
- ◆ Photovoltaic Module MFB105 (105W)
- ◆ Solar charge regulator PRS300
- ◆ Fixing kits KFPB530
- ◆ Cable entry gland KT6-PG
- ◆ Wiring kits KT51-C50

MFB105 105W

MODEL	MFB105
CODE	215981B
TYPE	PERC (Passivated Emitter and Rear Cell)
CELLS NUMBER	36
RATED VOLTAGE	12 V
MAX POWER	105 W
TOLERANCE	+3 %
OPEN CIRCUIT VOLTAGE	23,76 V
SHORT CIRCUIT CURRENT	5,33 A
VOLTAGE AT MAX POWER	20,88 V
CURRENT AT MAX POWER	5,03 A
DIMENSIONS (mm)	1062 x 530 x 30
WEIGHT (Kg)	6,2

PRS300

MODEL	PRS300
CODE	204274
RATED VOLTAGE	12V
MAXIMUM POWER	300W
MAX POWER PHOTOVOLTAIC MODULES	2
PERFORMANCE	
AUTOMATIC SHUTDOWN	In the absence of sunlight
END-OF-CHARGE VOLTAGE	14,1V (A) - 14,3V (B) - 14,7V (C)
FLOAT VOLTAGE	13,5V(A) - 13,8V(B) - 13,8V(C)
BATTERY TYPE SELECTOR	3 position dip-switch
NUMBER OF CHARGE LINES	3
BATTERY DESULPHATION	YES
REVERSE CURRENT BLOCKING PROTECTION	Electronic
REVERSE POLARITY PROTECTION	YES
TEST PANEL CONNECTION	PT 742
DIMENSIONS (mm)	115 x 90 H37

KFPB530



MODEL	PART-NR	DIMENSIONS (mm)	WEIGHT (Kg)
KFPB530 (black)	250410B	530 x 60 x 50	0,45

KT6-PG



MODEL	PART-NR	CABLE ENTRY GLAND complete with Pg16 cable gland for 2 cables with outer diameter 6mm ² .
KT6-PG	707063	

KT51-C50



MODEL	PART-NR	WIRING KIT FOR latest series of CBE photovoltaic modules complete with UV-resistant cable, 2x4 mm ² , length 5 metres.
KT51-C50	707073	

LINK A USER MANUAL FOR PRS300

You can download the full version of the user manual at the following link or by scanning the QR Code:

- <https://cbe.it/en/Catalogues>



WIRING DIAGRAM

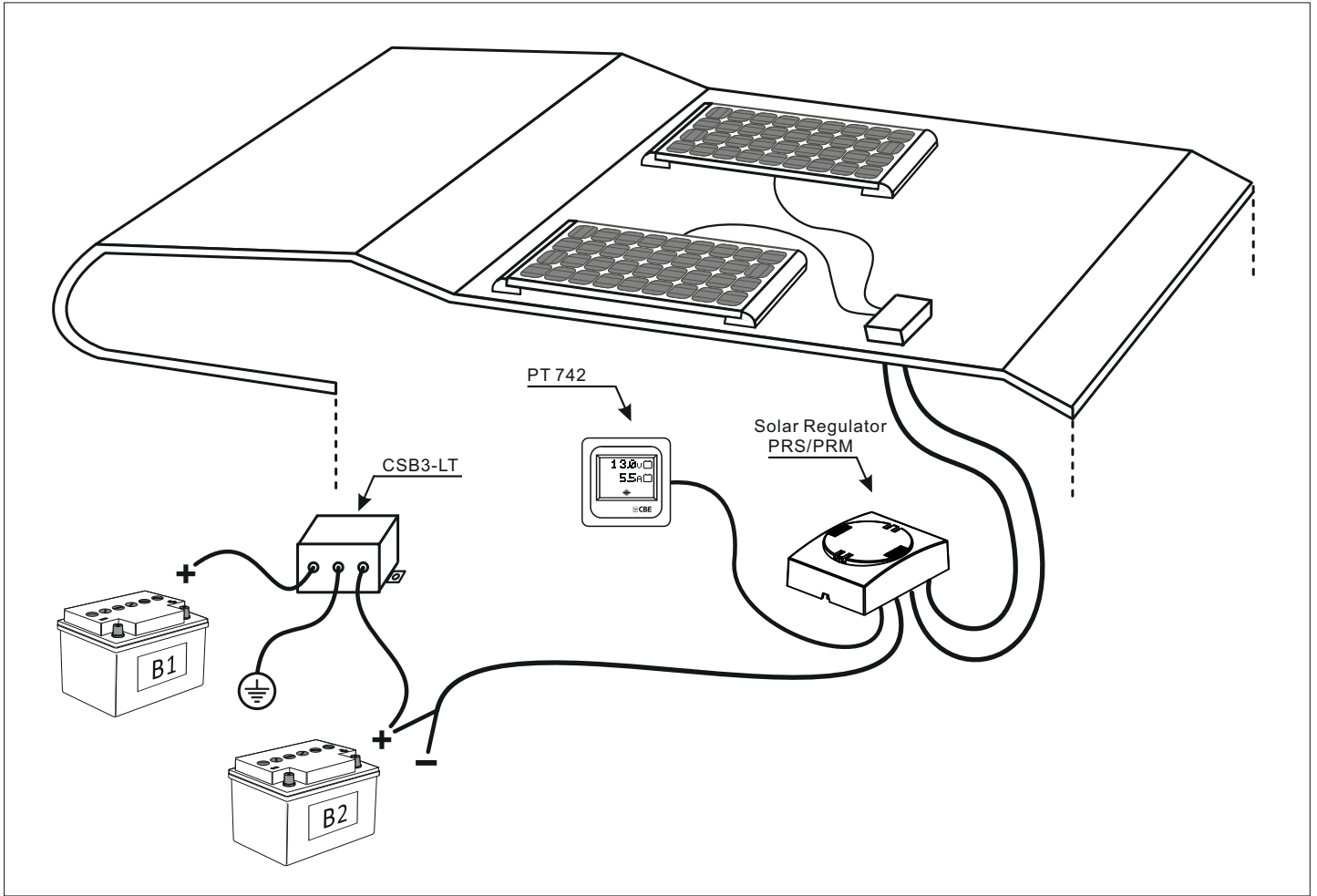

«KFPx» PHOTOVOLTAIC MODULE FIXING KIT

SPECIFICATIONS

- Specifically designed for motorhomes and caravans.
- Easy to install, no holes required.
- It can be installed in a few minutes with glue.
- It can be also installed on uneven surfaces.
- Light and aerodynamic.
- Anodized aluminium structure.





INSTALLATION

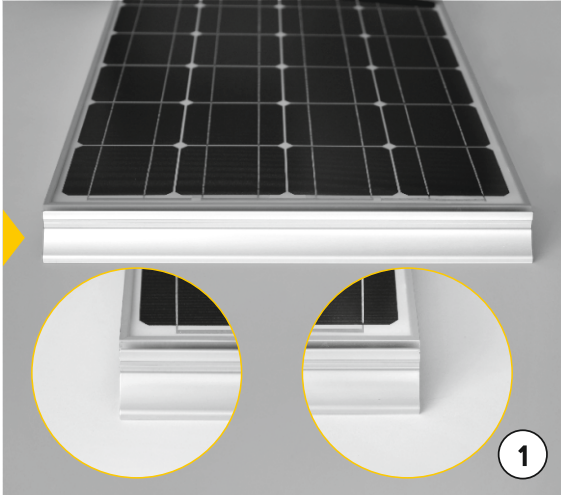

Position the photovoltaic module on the aluminium spoiler (central alignment).

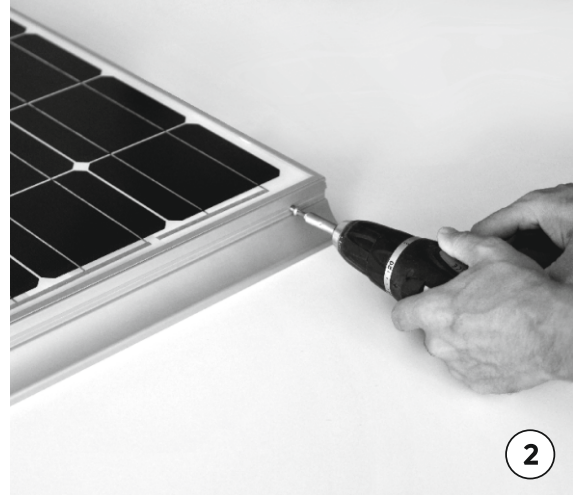

Use the two self-drilling screws to fasten the spoiler and the panel together.

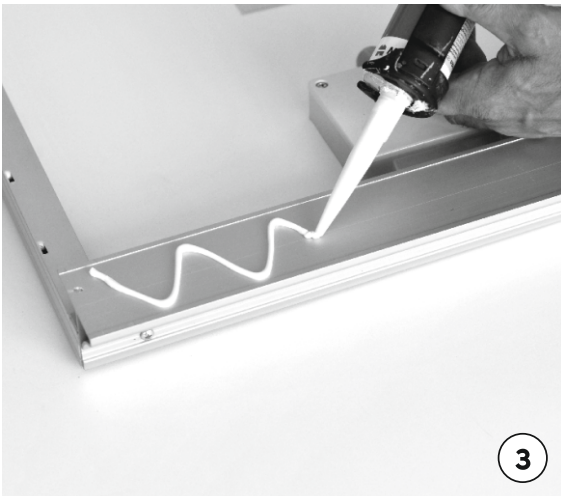

Spread the weatherproof polyurethane glue on the spoiler.



Use a degreasing agent to clean the motorhome roof and glue the spoiler on it. Let the glue dry.

ATTENTION: Glue not included in the package.
