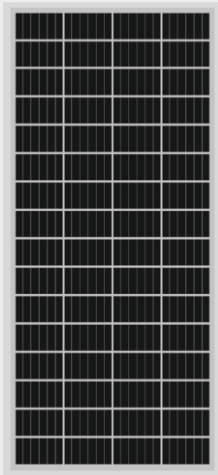

KIT PHOTOVOLTAIC MODULES

KIT 200 LARGE STD

- ◆ Code 215693
- ◆ Photovoltaic Module MF200 (200W)
- ◆ Solar charge regulator PRM400
- ◆ Fixing kits KFPN700
- ◆ Cable entry gland KT6-PG
- ◆ Wiring kits KT51-C50

MF200 200W

MODEL	MF200
CODE	215985
TYPE	PERC (Passivated Emitter and Rear Cell)
CELLS NUMBER	64
RATED VOLTAGE	12V
MAX POWER	200W
TOLERANCE	+3 %
OPEN CIRCUIT VOLTAGE	21,12V
SHORT CIRCUIT CURRENT	11,42 A
VOLTAGE AT MAX POWER	18,56 V
CURRENT AT MAX POWER	10,78 A
DIMENSIONS (mm)	1400 x 704 x 35
WEIGHT (Kg)	11,6

PRM400

MODEL	PRM400
CODE	204286
RATED VOLTAGE	12V
MAXIMUM POWER	350W (32+40 cells) – 400W (41+72 cells)
MAX POWER PHOTOVOLTAIC MODULES	2
PERFORMANCE	>95%
AUTOMATIC SHUTDOWN	In the absence of sunlight
END-OF-CHARGE VOLTAGE	-
FLOAT VOLTAGE	-
BATTERY TYPE SELECTOR	4 position dip-switch
NUMBER OF CHARGE LINES	8
BATTERY DESULPHATION	YES
REVERSE CURRENT BLOCKING PROTECTION	Electronic
REVERSE POLARITY PROTECTION	YES
TEST PANEL CONNECTION	PT 742
DIMENSIONS (mm)	150 x 110 H48



KFPN700



MODEL	PART-NR	DIMENSIONS (mm)	WEIGHT (Kg)
KFPN700	250430	700 x 60 x 50	0,60

KT6-PG



MODEL	PART-NR	CABLE ENTRY GLAND complete with Pg16 cable gland for 2 cables with outer diameter 6mm ² .
KT6-PG	707063	

KT51-C50



MODEL	PART-NR	WIRING KIT FOR latest series of CBE photovoltaic modules complete with UV-resistant cable, 2x4 mm ² , length 5 metres.
KT51-C50	707073	

LINK A USER MANUAL FOR PRM400

You can download the full version of the user manual at the following link or by scanning the QR Code:

- <https://cbe.it/en/Catalogues>



WIRING DIAGRAM

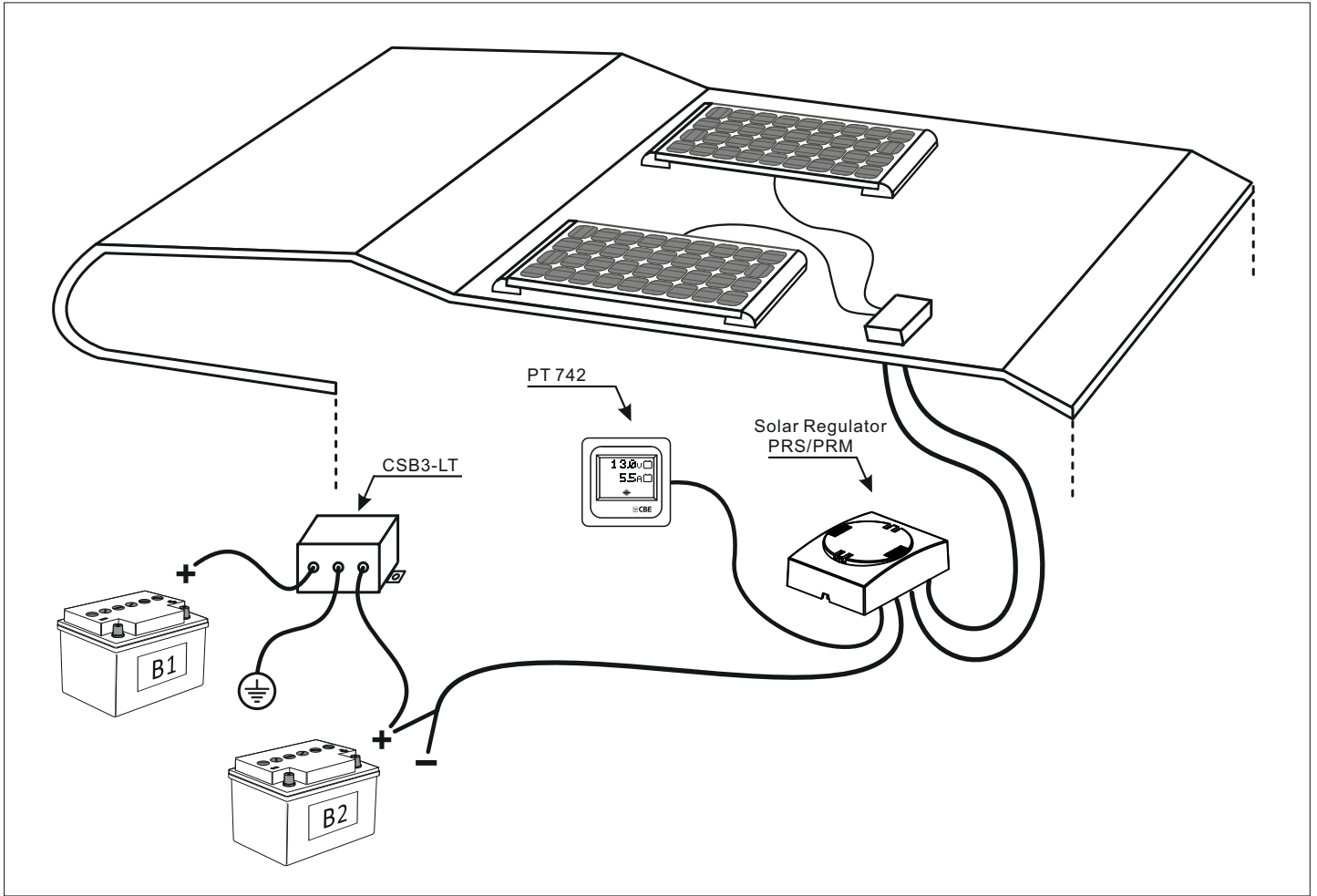

«KFPx» PHOTOVOLTAIC MODULE FIXING KIT

SPECIFICATIONS

- Specifically designed for motorhomes and caravans.
- Easy to install, no holes required.
- It can be installed in a few minutes with glue.
- It can be also installed on uneven surfaces.
- Light and aerodynamic.
- Anodized aluminium structure.





INSTALLATION

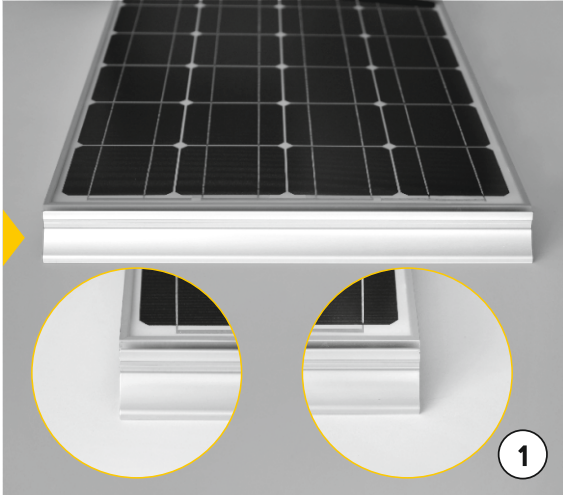

Position the photovoltaic module on the aluminium spoiler (central alignment).

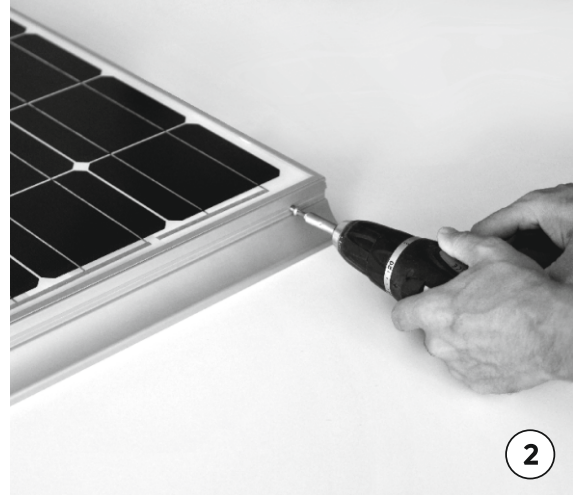

Use the two self-drilling screws to fasten the spoiler and the panel together.

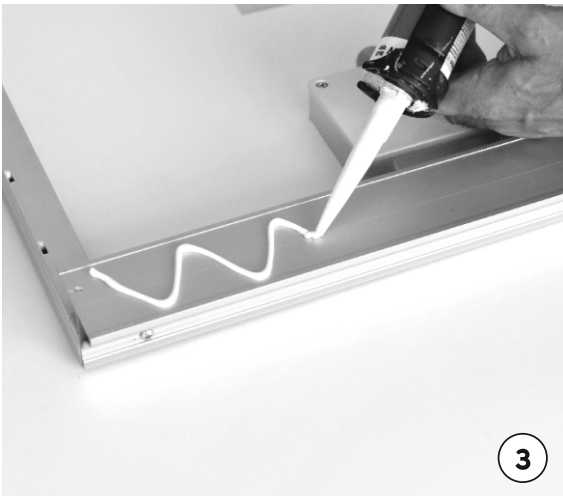

Spread the weatherproof polyurethane glue on the spoiler.



Use a degreasing agent to clean the motorhome roof and glue the spoiler on it. Let the glue dry.

ATTENTION: Glue not included in the package.
